

BALL LOCK PUNCHES

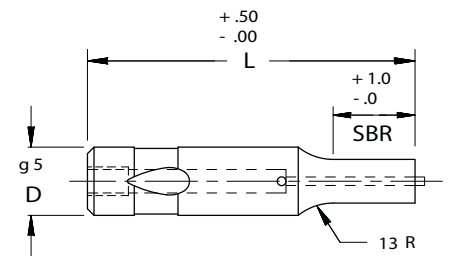

LIGHT DUTY/EJECTOR

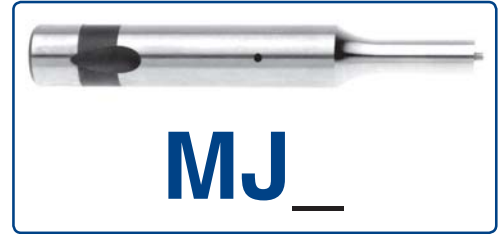
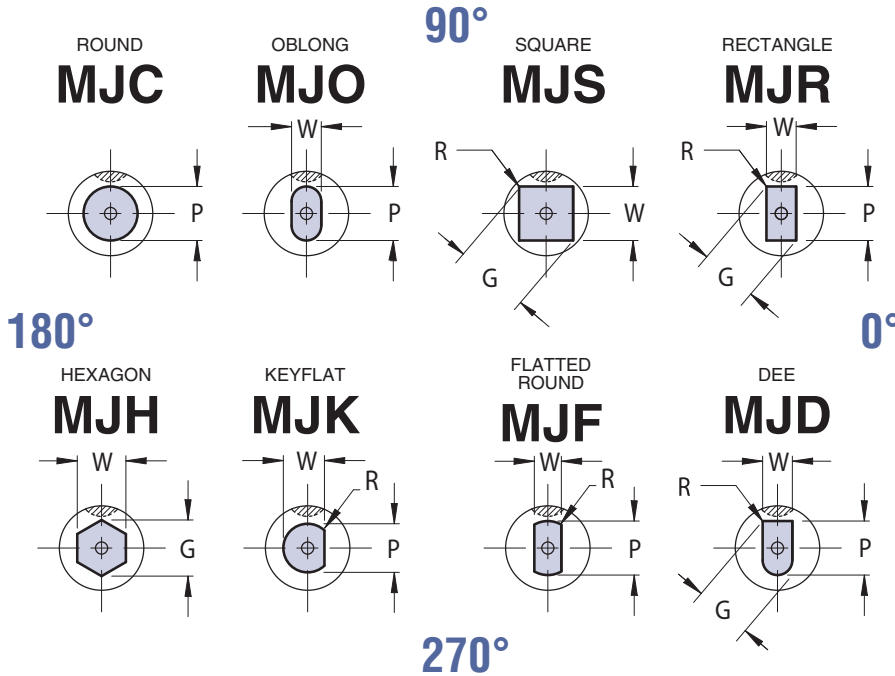

ORDER EXAMPLE:

(Reference page 4)	QTY:	TYPE	"D"	"L"	POINT LENGTH	P(OR P&W) DIMENSIONS
EXAMPLE:	6	MJC	16	90	STD	10.0
EXAMPLE:	6	MJO	13	80	B	10.0 x 7.0

Note: When ordering, standard quantity breaks are: 1, 2-3, 4-11, 12-23, 24-49, 50-99

VIEWS ARE SHOWN LOOKING THROUGH THE SHANK BUT DRAWN WITH SOLID LINES FOR CLARITY.

Complete design & CAD files visit WWW.MOELLERMCAD.COM

FOR STANDARD ALTERATIONS SEE PAGES 59-63.

CATALOG TYPE	SHANK DIA D	ROUND	SHAPE		OVERALL LENGTH "L"				
		RANGE P	MIN W	MAX G/P	63	71	80	90	100
MJ_06	6	2.20 - 5.98	2.20	6.00	X	X	X	X	X
MJ_10	10	2.50 - 9.98	2.50	10.00	X	X	X	X	X
MJ_13	13	5.00 - 12.98	4.50	13.00	X	X	X	X	X
MJ_16	16	8.00 - 15.98	6.00	16.00	X	X	X	X	X
MJ_20	20	12.00 - 19.98	8.00	20.00	X	X	X	X	X
MJ_25	25	16.00 - 24.98	10.00	25.00	X	X	X	X	X

Material
Steel: M2, HRC 60-63

Standard Point Tolerance

Round P $\begin{matrix} +.01 \\ -.00 \end{matrix}$ Ⓞ .01 P to D

Shape P, W $\pm .01$ Ⓞ .02 P to D

When P = D Shank Tolerances Apply

CATALOG TYPE	SHANK D	SBR			EJECTOR SIZE
		NAPMA STD	ALTERNATES		
			B	C	
MJ_06	6	13	10	—	MAE 3
MJ_10	10	19	10	—	MAE 4
MJ_13	13	19	13	25	MAE 5
MJ_16	16	19	13	25	MAE 5
MJ_20	20	19	13	25	MAE 6
MJ_25	25	19	13	25	MAE 6

L=71 SBR MAX=19

STANDARD BALL SEAT LOCATION IS AT 90° AS SHOWN. AVAILABLE AT 0°, 180°, 270°, FOR SAME PRICE.